

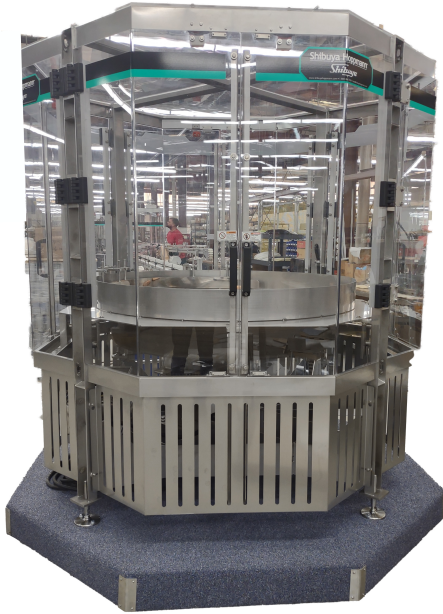

Shibuya Hoppmann

FTS-50

Centrifugal Feeder



Product Overview:

Shibuya Hoppmann’s standard FTS-50 rigid disc centrifugal feeder is designed to feed a variety of products with its unique design. Product is metered into the bowl and brought out to the bowl rim where a series of qualifiers gently orient the part for transfer to various downstream inline devices.

Part Number	FTS501RLASA
Motor Style	AC
Motor Voltage	208-230/460V
Horsepower	1/2 HP
Total Equipment Weight	1350 lbs

Standard Features:

- All Stainless Steel Construction
- Stainless Steel Bowl and Center Disc
- Completely Enclosed Polycarbonate Safety Covers
- Dual Drive System
- Washdown Motors
- Platform Tooling with quick removal for cleaning
- Lower Frame designed to limit flat surfaces where product may accumulate
- Lower cover design to allow for laminar air flow
- Completely Sealed Spindle Assembly to restrict fluid access.
- Hygienic Leveling Feet

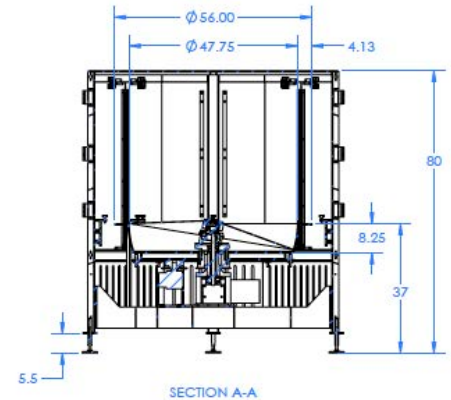
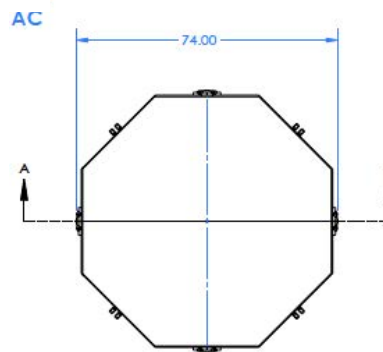

Product Specifications	ANSI	Metric
Outside Width	74"	1880mm
Overall Height	80"	2023mm
Discharge Height	37" ± 2"	940mm
Bowl Outside Diameter	56"	1422mm
Bowl Inside Diameter	47.75"	1213mm
Rim Width	2"	50.8mm
Bowl Depth	8.25"	210mm

Optional Accessories:

Clockwise: Backup Ring	BUCWFT50SU
Counter-Clockwise: Backup Ring	BUCCFT50SU

Headquarters
 7849 Coppermine Dr
 Manassas, VA
 20109
 540.829.2564 t
 800.368.3582 t
 540.829.1726 f

Sales Office
 1445 Brookville Way
 Suite F
 Indianapolis, IN 46239
 317.322.0754 t
 800.368.3582 t
 317.322.0794 f

Manufacturing Office
 291 Dillard Road
 Madison Heights, VA
 24572
 434.929.4746 t
 800.543.0915 t
 434.929.4959 f

www.ShibuyaHoppmann.com | sales@ShibuyaHoppmann.com

Shibuya Hoppmann Corporation strives to improve its products and reserves the right to change or discontinue specifications & designs shown in this brochure without notice and without incurring obligation. Revised: 1/20.