



Product Overview:

Our brand new Hoppmann™ FS-70 scallop centrifugal feeder is created to feed small, medium or large parts at high rates with its unique design, custom scallops and robust construction, and is one of the largest centrifugal feeders available on the market today. Parts are radially oriented and gently qualified in the scallop pockets by means of qualifiers, wipers, pneumatic and/or electrical devices depending on specific product characteristics. Note: Tooling and scallops are not included with this standard unit.

Part Number	FS701RLASA
Motor Style	AC
Motor Voltage	208 - 230/460V
Horsepower	1hp
Total Equipment Weight	1600 lbs. / 726 kg

Standard Features:

- All stainless steel exterior construction
- FDA approved ABS vacuum formed disc
- Teflon Hardcoat Anodized aluminium bowl predrilled for scallop mounting
- Air clutch
- Hinged polycarbonate cover with safety interlocks
- Backup Ring

Available Options:

- Washdown motor(s)
- Custom urethane scallop kit
- NEMA 1 encased controller

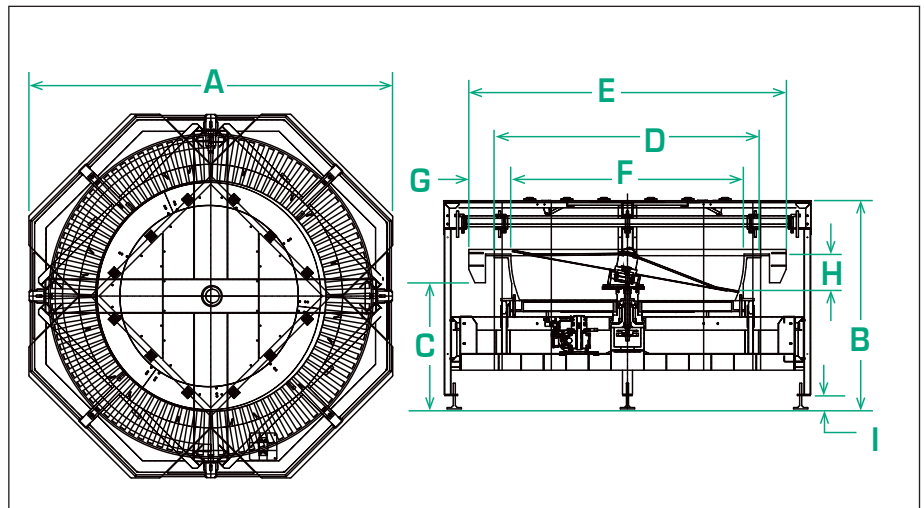

Product Specifications	ANSI	Metric
A Outside Width	110.50"	2807.0mm
B Overall Height	63.00"	1600.0mm
C Bowl Discharge Height	36.00"	914.4mm
D Bowl Outside Diameter	70.00"	1778.0mm
E Scallop Edge Outside Diameter	94.00"	2387.6mm
F Bowl Inside Diameter	70.00"	1778.0mm
G Rim Width	5.00"	127.0mm
H Bowl Depth	9.50"	241.3mm
I Level Foot Adjustment	5.00" ± 2.00"	127.0 ± 50.8mm